

2012 INDIANA CHURCH OF GOD YOUTH CAMP APPLICATION

PLEASE PRINT OR TYPE IN BLACK INK and mail to:
Church of God Youth Camp, PO Box 38, Greenwood, IN 46142.

Camp Fees: Early Bird Deadline: June 1, 2012 HS & MS Camp - \$125.00 Kids Camp - \$115.00
After June 1, 2012 HS & MS Camp - \$145.00 Kids Camp - \$135.00
Day of Camp Walk-on HS & MS Camp - \$165.00 Kids Camp - \$155.00

A deposit of \$50.00 is due with every application. The remainder of camp fee is due at camp registration. Deposits and paid fees are non-refundable, but may be transferred, with permission from the State Y&D Director. A free 2012 Camp T-Shirt is included in registration costs. Please mark application for appropriate size. Size is guaranteed on applications received by Early Bird deadline **only**. **(Discover, MasterCard, & Visa accepted—Fill out form on back)**

Name _____ Email: _____

Mailing Address _____

City _____ State _____ Zip _____ - _____

Age _____ Date of Birth _____ / _____ / _____ Gender: Male Female

Home # (____) _____ Father's Work/Cell # (____) _____ Mother's Work/Cell # (____) _____

Parents/Guardian _____ Local Church _____

Cabin Roommate Preference #1 _____ #2 _____

I will attend the: (Please check one)

High School Camp (June 25-June 29)
Grades 9 – 12

Middle School Camp (July 2-6)
Grades 5 – 8

Kids Camp (July 9-12)
Grades K - 4

Free 2012 Camp T-Shirt Size: (Circle one) YS YM YL AS AM AL AXL AXXL AXXXL

MEDICAL INFORMATION

Health deficiencies or medical conditions _____

List all drug allergies _____

List all food or severe allergies _____

Date of last tetanus shot? _____

Family Physician _____ Address _____ Phone(____) _____

Insurance Carrier _____ Policy # _____ Group # _____

ALL MEDICATIONS MUST BE SENT TO CAMP IN ORIGINAL PRESCRIPTION BOTTLES!

I release the Church of God, its agents, employees, and volunteer workers from any liability whatsoever arising out of injury, sickness, or damage which may be sustained by my child (named on this form) while attending Youth Camp. I authorize the camp nurse and other trained camp staff to administer basic first aid as necessary. (This would include, but not be limited to: wound care, ice packs, bandages, the administering of antacids, antihistamines, pain reliever/fever reducing medication, etc.) I understand that a camp nurse administers all medications taken at camp. Prescription medications are dispensed as prescribed. In an emergency, I hereby give permission to a Licensed Physician selected by the camp to hospitalize, provide proper treatment, anesthesia, or surgery, as medically necessary, for my child.

Additionally, I hereby grant permission for my child to appear in camp photographs and/or camp videos, and grant permission for use of said images of my child in future camp advertisements.

Parent/Guardian Signature _____

(A Parent or Legal Guardian **MUST** sign this form)

I hereby pledge to abide by the Code of Conduct and policies of the camp during my stay, and adhere to the dress code.

Camper Signature _____ Pastor's Endorsement Signature _____

Should my child desire to be baptized in water, I hereby authorize and release the Church of God Youth and Discipleship Department personnel to perform the sacrament during camp without further notice.

Parent/Guardian Signature _____

FOR OFFICE USE ONLY – DO NOT WRITE IN THIS SPACE Date Received _____ / _____ / _____

Deposit Paid \$ _____ Check # _____ Credit Card: D / MC / V Balance \$ _____

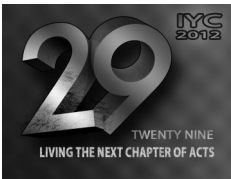

Indiana Church of God Youth Camp Credit Card Payment Form

Card Type: (circle one) Visa / MasterCard / Discover

Card # _____

Expiration Date _____ / _____ / _____

Name on Card _____

Billing Address _____

City _____ State _____ Zip _____

Billing Telephone (_____) _____ - _____

Amount of this charge: \$ _____ + \$5.00 processing fee
(A \$5.00 processing fee will be added for all credit/debit card payments.)

Signature _____

1 Once barely on shore, we found out that the island was called Malta. 2 The Islanders showed us unusual hospitality because it was raining and cold. 3 Paul gathered the people around the fire, a viper, driven out by the heat, fastened itself on his hand, they thought he was a snake, hanging from his hand, they said, "This man must be a madman, for though he escaped from the sea, he has not allowed himself to be burned." 4 Paul said, "I am not harmed, but I will shake myself clean. But since you have done this, I must go on to the fire and suffer no harm." 5 But as he stepped on the fire and suffered no harm, the people expected him to suddenly fall head out after waiting a long time and an unusual happening. 6 Paul stood on their heads and said he was a god. 7 They thought he was a madman. 8 Paul was sick in bed, surrounded by many people. Paul went to see him and, at the prayers, placed his hands on him and healed him. 9 When this had happened, the rest of the sick on the island came and were cured. 10 They honored us in many ways; and when we were ready to sail, they furnished us with the supplies we needed.



2012 INDIANA YOUTH CAMP FACT SHEET

- CAMP SPEAKERS:** Stephen "The Burnin'" Bush - High School Camp
Matt Kidd - Middle School Camp
Kevin & Melinda Edgington & Raise2Praise - Kids Camp
- CAMP SCHEDULE FEATURES:** Electives, Fun with the Word, Recreation, Balloon-A- Grams, Into the Word, Awesome Antics, Swimming, Exciting Worship, Spirit Stick, and much more!!!
- CAMP CANTEEN:** Available throughout the day in all camps to sell refreshments. You will want to bring some spending money for this.
- HEAD CHECK:** In keeping with the policy of many schools and child-care facilities, every camper will be checked for head lice before they are allowed to check in their room. This process will be handled very discreetly and professionally. However, anyone with head lice or nits will not be admitted to camp. **It is recommended each camper be checked before leaving home.**
- VISITORS AT CAMP:** Because visits can be very disruptive to the camp schedule, we ask none be made during the day. However, everyone is welcome to attend our worship services H.S. - 7:00 PM, M.S. 6:45 PM, and Kids 6:30 PM. For security reasons, all visitors will be asked to check in, wear a visitor's badge, and leave the campground as soon as church is over. **Phone calls are highly discouraged.**
- CHECK IN:** Registration and check in is from 1:00-2:30PM on the Monday of all Camps. Campers should not plan to arrive on the campground before this time.
- CHECK OUT:** Campers are to check out at 9:00 AM on the Friday of High School, and Middle School Camp, and 9:00 AM on Thursday of Kids Camp.
- MEDICINE AT CAMP:** Any necessary medications should be brought to camp in their original container. All medications will be kept in the nurse's station and administered from there.

Indiana Youth Camp

Code of Conduct

1. All Campers will be under the supervision of their Cabin Leader at all times.
2. **No cell phones**, I Pods, MP3 players, or other electronic devices are allowed at camp. Any of the above items discovered at camp will be confiscated and held in the camp office until check-out.
3. Alcohol, tobacco and illegal drugs are strictly prohibited. All medication brought to camp must be left with the camp nurse.
4. No fireworks, firearms, knives or other weapons are allowed.
5. All campers are expected to attend all camp activities unless excused by the Head Cabin Leader.
6. All campers and workers must adhere to the dress code. In general, clothing deemed immodest or inappropriate for particular activities will not be allowed at camp. The following guidelines should be observed:

RECREATION: Bring play clothes (no tank tops, strapless tops or halter tops — shorts of modest length are allowed); swimsuit and cover-up (girls are encouraged to wear one-piece suits); and athletic shoes.

FOR EVENING WORSHIP (HS & MS Camps Only):

Clothing considered appropriate for normal Sunday evening and/or Wednesday worship/youth group should be worn to youth camp evening worship. This honors God by presenting oneself before Him as prepared for worship.

7. Everyone at camp will be expected to help keep the grounds and facilities clean. Dorm rooms will be inspected daily.
8. All automobiles are to remain parked until camp is dismissed. No one may leave the grounds without special permission from the Camp Director. This includes campers and staff.
9. No camper is to be out of their dorm after “lights out” or before “reveille.”
10. Any breach of proper conduct or disregard of camp rules will result in disciplinary action. Serious or repeated infractions will result in dismissal from camp.

THINGS TO BRING

- Appropriate clothes for church (refer to the code of conduct)
- Appropriate clothes for recreation (you will get dirty!)
- Bedding for bunks
- Towels and washcloths
- Toiletries
- Plastic bag for dirty clothes
- Swimsuit
- Sweater/light jacket
- Tennis shoes (they will get dirty)
- Medication in original container inside a zip lock bag
- Bible, notebook, and pen
- Spending money for canteen
- LOTS OF CAMP SPIRIT!!!!



THINGS NOT TO BRING



- Cell Phones
- iPods / MP3 Players
- Radios
- Tobacco in any form
- Firearms, knives, fireworks, weapons
- Anything expensive

PLEASE NOTE

Anyone driving to camp will be expected to park his or her vehicle will need to remain parked until the individual has checked out the camp. Anyone leaving the campground without permission will be dismissed from camp.

Maps to Little League Central Region Complex Indianapolis, IN

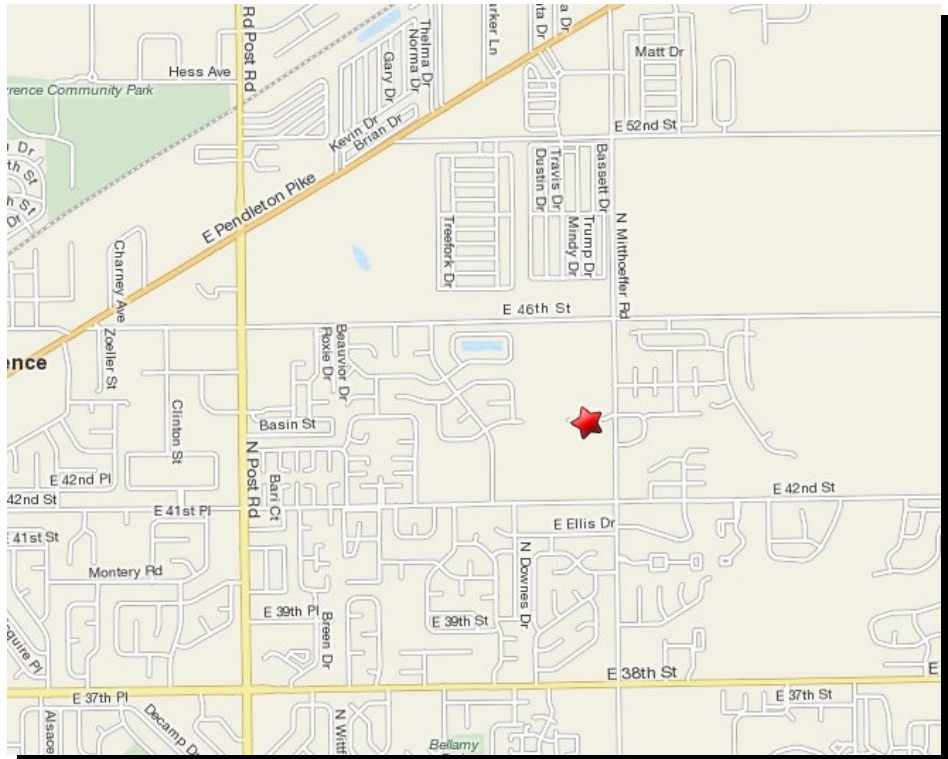
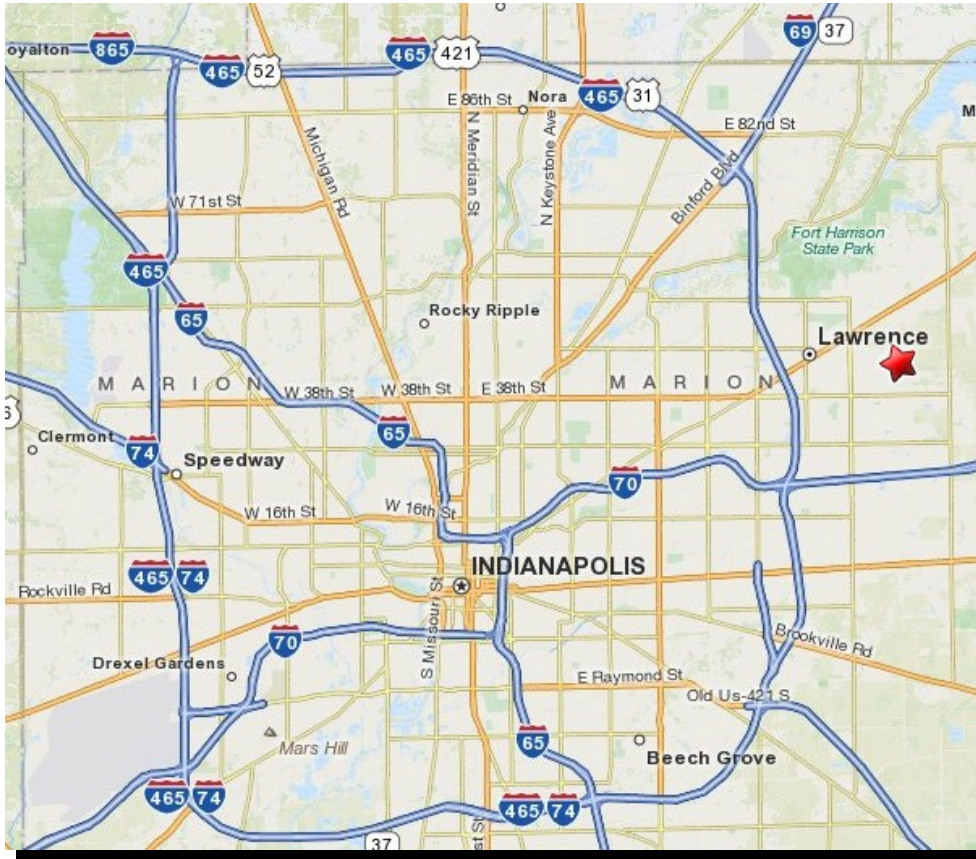

Physical Address:
9802 E. Little League Drive
Indianapolis, IN 46235